

Explosion-proof illumination

LED Light Fixture



IP65

Lowbay-B12 series



- 1 and 2 hazardous areas,
- IIA, IIB, IIC subgroup of category II (gas locations),
- IIIA, IIIB, IIIC subgroup of category III (dust locations).

Basic parameters of LED light fixture

Product name	Light flux, lm,	Power consumption, W	Explosion-proof construction	IP degree	Overall dimensions, mm	Weight, kg
Lowbay-B12-20 (SPV-220-005-01)	2800	20	1 Ex d e IIC T5 Gb/ Ex tb IIIC T100°C Db	IP65	212 x 210 x 180	4,5
Lowbay-B12-30 (SPV-220-005-02)	4200	30				
Lowbay-B12-40 (SPV-220-005-03)	5600	40				
Lowbay-B12-60 (SPV-220-005-04)	8400	60				

General parameters of LED light fixture

AC supply voltage, V	from 176 to 264
Frequency, Hz	50±10%
DC supply voltage, V	from 250 to 370
Operating temperature range, °C	from - 40 to + 50
Emission color	white
Color rendering index, CRI (Ra), not less	70
Color temperature of emission, K	4000÷6000
Electric shock protection class in accordance with IEC 60598-1, part 8	I
Climatic performance in accordance with State Standard 15150	MCC1
Light flux ripple rate, %, not more	10
Warranty, years	5
Durability, hours	50000

Light Distribution Curve

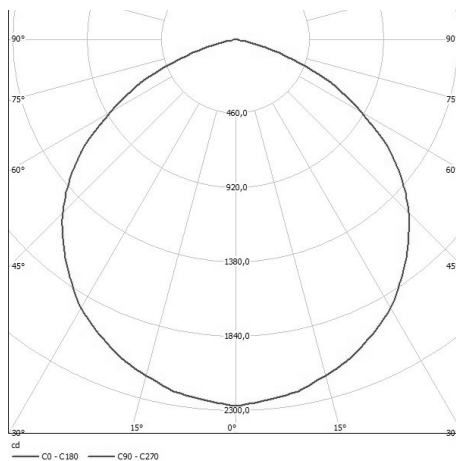

Overall dimensions of LED light fixture with bracket installation type

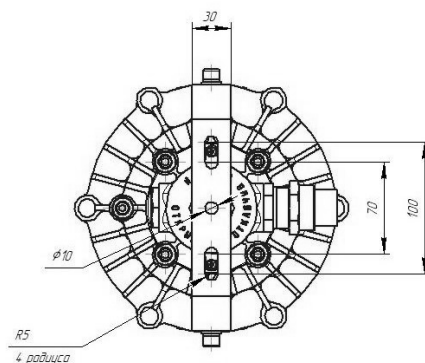
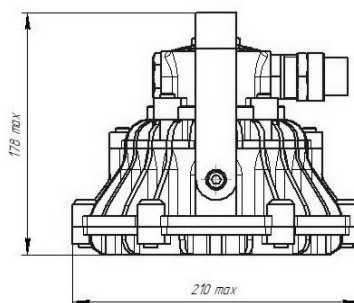
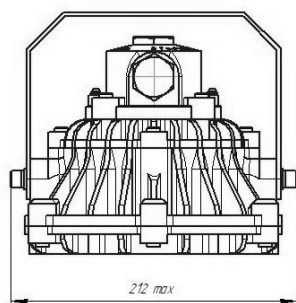

Pipe and eyebolt installation types are also possible.



JSC«Proton», 302040, Orel city, Leskova str., 19, tel./fax: (4862) 41-44-03
www.proton-orel.ru